



Aspinal Street, Birkenhead, CH41 4HZ

welcome to

Aspinall Street, Birkenhead

Warning!! you're about to fall in love... This spacious three-bed mid terraced house with a great-sized yard is perfect for first-timers. Blink and you'll miss it!



Property Description

First-time buyers, families and investors... get ready, because this one's got more space than you bargained for!

From the outside, you might think "nice terrace" but step inside and, plot twist, it just keeps going! This deceptively spacious three-bed mid-terrace is like a TARDIS, offering plenty of room to spread out and make yourself at home.

Located in a popular residential area, this property is perfect whether you're a first-time buyer, a growing family needing that extra elbow room, or an investor hunting for your next smart move.

Inside, you're welcomed by an entrance hall leading into a generous lounge, ideal for Netflix marathons, lazy Sundays, or pretending you'll host guests more often than you actually will. Just when you think that's enough space, surprise! There's also a separate dining room.

To the rear, the fitted kitchen is ready for action, whether you're a gourmet chef or more of a "oven on, job done" type.

Upstairs, the good news continues with two proper double bedrooms (no arguing over who gets the big one here) plus a versatile single bedroom, ideal for a nursery, office, or that walk-in wardrobe you've always dreamed about. A family bathroom completes the first floor.

The property also benefits from double glazing and gas central heating, because nobody likes being cold, let's be honest.

Step outside and you'll find a large, low-maintenance yard. And the best bit? No onward chain! Trust us, you'll kick yourself if you miss it!

Entrance Hall

Composite door and double-glazed window to the front and radiator.

Lounge

13' 6" x 11' 4" (4.11m x 3.45m)

Double-glazed bay window to the front and radiator.

Dining Room

10' 11" x 10' 7" (3.33m x 3.23m)

Double-glazed window to the rear and radiator.

Kitchen

8' 4" x 6' 8" (2.54m x 2.03m)

Fitted kitchen comprising wall and base cupboards, sink and drainer unit and work surfaces. Electric oven, induction hob and washing machine plumbing.

Double-glazed door to the rear.

First Floor Landing

Bedroom One

13' 6" x 11' 9" (4.11m x 3.58m)

Double-glazed bay window to the front and radiator.

Bedroom Two

11' 11" x 11' 9" (3.63m x 3.58m)

Double-glazed window to the rear and radiator.

Central heating boiler and built-in storage.

Bedroom Three

8' 2" x 5' 9" (2.49m x 1.75m)

Double-glazed window to the front and radiator.

Bathroom

Bathroom with three-piece suite comprising bath with shower over, wash hand basin and WC. Loft access and double-glazed window to the rear.

Outside

Rear Yard

Rear yard laid with flagstones and artificial lawn.



view this property online [jonesandchapman.co.uk/Property/PTN116758](https://www.jonesandchapman.co.uk/Property/PTN116758)



welcome to

Aspinall Street, Birkenhead

- Three Bedroom Mid Terraced House
- Spacious Lounge
- Dining Room
- Kitchen
- Bathroom

Tenure: Freehold EPC Rating: D
Council Tax Band: A

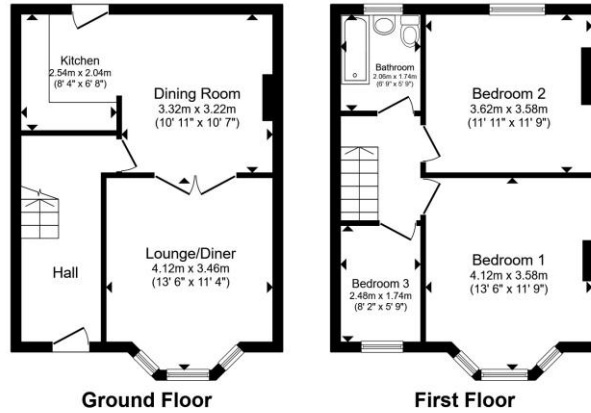

Total floor area 76.8 m² (826 sq.ft.) approx

This floor plan is for illustrative purposes only. It is not drawn to scale. Any measurements, floor areas (including any total floor area), openings and orientation are approximate. No details are guaranteed, they cannot be relied upon for any purpose and they do not form part of any agreement. No liability is taken for any error, omission or misstatement. A party must rely upon its own inspection(s). Powered by www.propertybox.co

jones & chapman

£150,000



Please note the marker reflects the postcode not the actual property

view this property online [jonesandchapman.co.uk/Property/PTN116758](https://www.jonesandchapman.co.uk/Property/PTN116758)



Property Ref:
PTN116758 - 0002

1. MONEY LAUNDERING REGULATIONS Intending purchasers will be asked to produce identification documentation at a later stage and we would ask for your co-operation in order that there is no delay in agreeing the sale. 2. These particulars do not constitute part or all of an offer or contract. 3. The measurements indicated are supplied for guidance only and as such must be considered incorrect. Potential buyers are advised to recheck measurements before committing to any expense. 4. We have not tested any apparatus, equipment, fixtures or services and it is in the buyers interest to check the working condition of any appliances. 5. Where an EPC, or a Home Report (Scotland only) is held for this property, it is available for inspection at the branch by appointment. If you require a printed version of a Home Report, you will need to pay a reasonable production charge reflecting printing and other costs. 6. We are not able to offer an opinion either written or verbal on the content of these reports and this must be obtained from your legal representative. 7. Whilst we take care in preparing these reports, a buyer should ensure that his/her legal representative confirms as soon as possible all matters relating to title including the extent and boundaries of the property and other important matters before exchange of contracts.

Jones & Chapman is a trading name of Sequence (UK) Limited which is registered in England and Wales under company number 4268443, Registered Office is Cumbria House, 16-20 Hockliffe Street, Leighton Buzzard, Bedfordshire, LU7 1GN. VAT Registration Number is 500 2481 05.

jones & chapman



0151 608 2287



Prenton@jonesandchapman.co.uk



349 Woodchurch Road, Prenton, PRENTON,
Merseyside, CH42 8PE



[jonesandchapman.co.uk](https://www.jonesandchapman.co.uk)