



Stoborough Crescent, Featherstone Pontefract WF7 5PE



Welcome to

Stoborough Crescent, Featherstone Pontefract

GUIDE PRICE £150,000 - £160,000 Ideal first time buy, this two bedroom end town house in Featherstone offers entrance hall, cloakroom, storage, and open plan lounge kitchen diner. First floor provides two bedrooms, bathroom and storage. Front garden, separate parking.



Entrance Hall

with a front entrance door, laminate flooring, under stairs storage and a gas central heating radiator.

Kitchen/Diner

17' 8" x 19' 4" (5.38m x 5.89m)

A fitted kitchen consisting of wall, base and drawer units with work surfaces over, electric oven and hob, stainless steel sink and drainer, extractor hood, space for washing machine, fridge freezer, dishwasher, tumble dryer, stainless steel splash back, part tiled part laminate flooring, three gas central heating radiators and two windows to the side.

Landing

With access to the loft and a cupboard housing the boiler.

Bedroom One

17' 8" x 9' 2" (5.38m x 2.79m)

With two windows to the side, a window to the front and a gas central heating radiator.

Bedroom Two

6' 10" x 7' 9" (2.08m x 2.36m)

With a window to the front, bulk head storage and a gas central heating radiator.

Bathroom

With a low level flush WC, wash hand basin, bath with shower over, extractor fan, tiled over bath and tiled flooring.



view this property online williamhbrown.co.uk/Property/PON119885



Welcome to

Stoborough Crescent, Featherstone Pontefract

- *****GUIDE PRICE £150,000 - £160,000*****
- Two Bedroom End Town House
- Off Street Parking
- Open Plan Living Space
- Ideal For First Time Buyers

Tenure: Freehold EPC Rating: B

Council Tax Band: A

guide price

£150,000 - £160,000

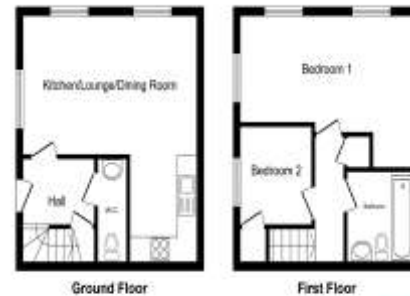

Please note the marker reflects the postcode not the actual property

view this property online williamhbrown.co.uk/Property/PON119885



Property Ref:
PON119885 - 0002

1. MONEY LAUNDERING REGULATIONS Intending purchasers will be asked to produce identification documentation at a later stage and we would ask for your co-operation in order that there is no delay in agreeing the sale. 2. These particulars do not constitute part or all of an offer or contract. 3. The measurements indicated are supplied for guidance only and as such must be considered incorrect. Potential buyers are advised to recheck measurements before committing to any expense. 4. We have not tested any apparatus, equipment, fixtures or services and it is in the buyers interest to check the working condition of any appliances. 5. Where an EPC, or a Home Report (Scotland only) is held for this property, it is available for inspection at the branch by appointment. If you require a printed version of a Home Report, you will need to pay a reasonable production charge reflecting printing and other costs. 6. We are not able to offer an opinion either written or verbal on the content of these reports and this must be obtained from your legal representative. 7. Whilst we take care in preparing these reports, a buyer should ensure that his/her legal representative confirms as soon as possible all matters relating to title including the extent and boundaries of the property and other important matters before exchange of contracts.

William H Brown is a trading name of Sequence (UK) Limited which is registered in England and Wales under company number 4268443, Registered Office is Cumbria House, 16-20 Hockliffe Street, Leighton Buzzard, Bedfordshire, LU7 1GN. VAT Registration Number is 500 2481 05.



william h brown



01977 791406



Pontefract@williamhbrown.co.uk



26 Market Place, PONTEFRAC, West Yorkshire,
WF8 1AT



williamhbrown.co.uk