



## Building plot, 1 Kingsbury Court

Scawthorpe, Doncaster, DN5 7TJ

Offers Around £150,000

A rare opportunity has arisen to purchase a single building plot on a select development of just 6 high quality detached homes, Full planning consent has been granted for a detached property, of around 170 sq m. The build is already up to damp proof course with all services in place. Proposed accommodation briefly comprises of ; reception hall, living room, open plan kitchen with family and dining area, study, utility room, WC. Master bedroom suite with ensuite shower room, 3 further bedrooms and house bathroom. Outside; ample off road parking and garage.

Scawthorpe is a very popular village, with reputable primary and secondary schools, a range of amenities, pubs and restaurants and easy access to the A1 motorway.

- Building plot
- Full planning granted for a 4 bedroom detached house with double garage
- Built to damp proof course with all services in place
- Modern development of only 6 properties
- Sought after location
- Close to amenities, reputable schools and motorway connections

### Viewing

Please contact our Office on 01302 751616 if you wish to arrange a viewing appointment for this property or require further information.



# Floor Plan

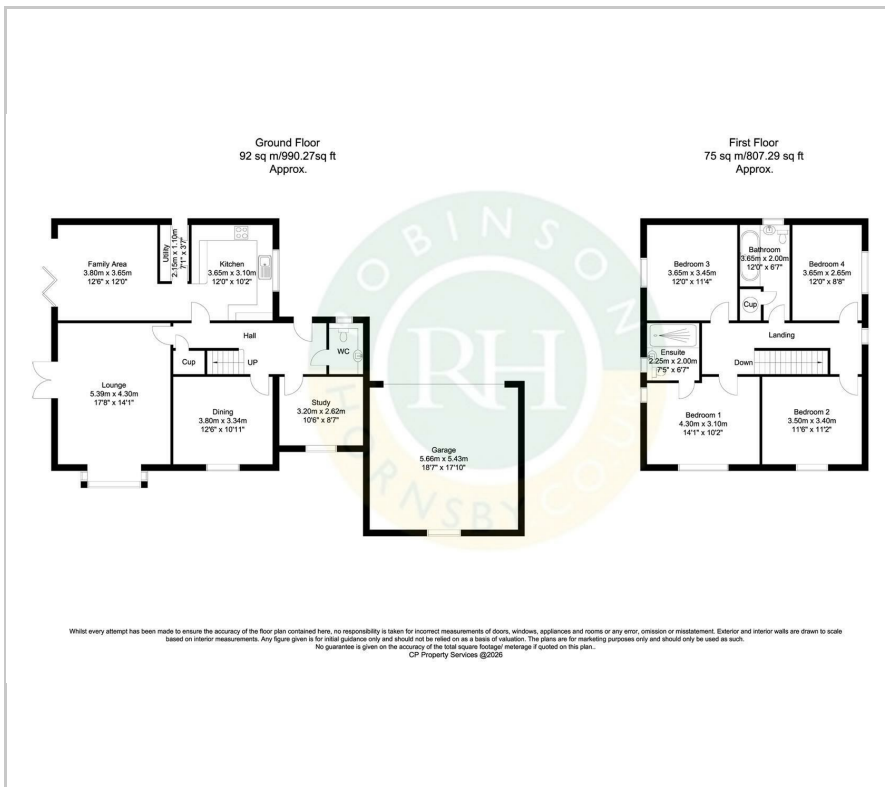

# Area Map

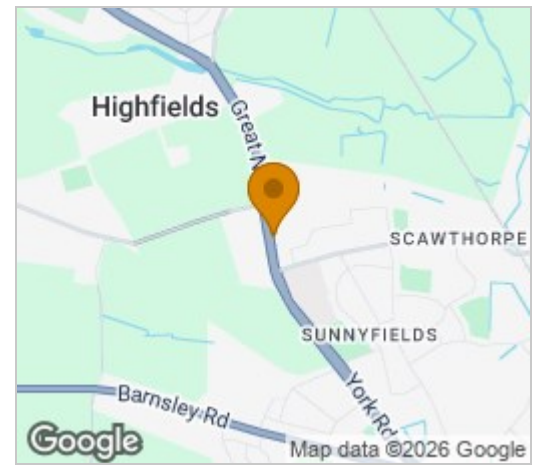

# Energy Efficiency Graph

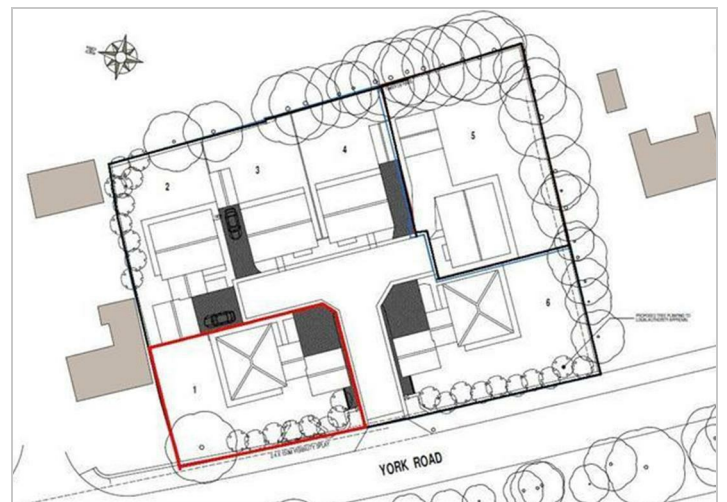
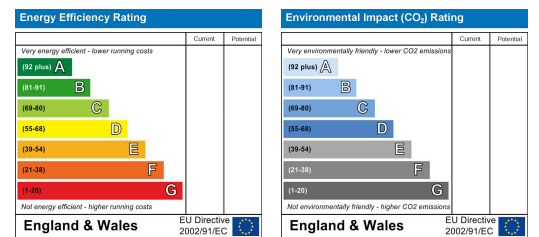

These particulars, whilst believed to be accurate are set out as a general outline only for guidance and do not constitute any part of an offer or contract. Intending purchasers should not rely on them as statements of representation of fact, but must satisfy themselves by inspection or otherwise as to their accuracy. No person in this firm's employment has the authority to make or give any representation or warranty in respect of the property.