



Kingfisher House Walton Street, Aylesbury HP21 7FS

welcome to

Kingfisher House Walton Street, Aylesbury

Offered for sale is a well-presented, two-bedroom ground floor apartment, ideally situated in the heart of Aylesbury. This light and spacious residence is perfect for those seeking a comfortable home in a prime location. The apartment boasts a good-sized layout, providing ample space for both relaxation and entertaining. Natural light fills the property, creating a welcoming and airy atmosphere throughout the living areas. Each bedroom is generously proportioned, allowing for flexible use and comfortable living.



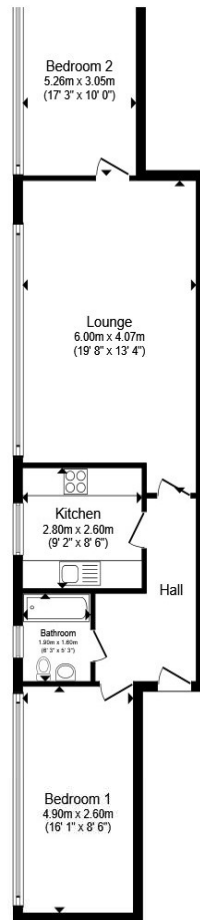

Floor Plan 1

Total floor area 69.8 m² (752 sq.ft.) approx

This floor plan is for illustrative purposes only. It is not drawn to scale. Any measurements, floor areas (including any total floor area), openings and orientation are approximate. No details are guaranteed, they cannot be relied upon for any purpose and they do not form part of any agreement. No liability is taken for any error, omission or misstatement. A party must rely upon its own inspection(s). Powered by www.propertybox.io



Nestled within a sought-after area, the apartment benefits from excellent proximity to Aylesbury town centre, where a wealth of shops, cafés, and amenities can be enjoyed just a short stroll away. Commuters will appreciate the nearby Aylesbury train station, offering direct links to London and surrounding areas, making travel both easy and convenient.

Accommodation Comprises

Entrance Hall

Kitchen

Lounge

Bedroom Two

Bathroom

Bedroom One

Outside

Residents Parking

welcome to

Kingfisher House Walton Street, Aylesbury

- GROUND FLOOR APARTMENT
- TWO BEDROOMS
- SPACIOUS LIVING ACCOMMODATION
- TOWN CENTRE LOCATION
- IDEAL FIRST TIME PURCHASE

Tenure: Leasehold EPC Rating: D

Council Tax Band: B Service Charge: 2301.20

Ground Rent: 200.00

This is a Leasehold property. We are awaiting further details about the Term of the lease. For further information please contact the branch. Please note additional fees could be incurred for items such as Leasehold packs.

offers over

£220,000



Please note the marker reflects the postcode not the actual property

view this property online [brownandmerry.co.uk/Property/AYL115740](https://www.brownandmerry.co.uk/Property/AYL115740)



Property Ref:
AYL115740 - 0002

1. MONEY LAUNDERING REGULATIONS Intending purchasers will be asked to produce identification documentation at a later stage and we would ask for your co-operation in order that there is no delay in agreeing the sale. 2. These particulars do not constitute part or all of an offer or contract. 3. The measurements indicated are supplied for guidance only and as such must be considered incorrect. Potential buyers are advised to recheck measurements before committing to any expense. 4. We have not tested any apparatus, equipment, fixtures or services and it is in the buyers interest to check the working condition of any appliances. 5. Where an EPC, or a Home Report (Scotland only) is held for this property, it is available for inspection at the branch by appointment. If you require a printed version of a Home Report, you will need to pay a reasonable production charge reflecting printing and other costs. 6. We are not able to offer an opinion either written or verbal on the content of these reports and this must be obtained from your legal representative. 7. Whilst we take care in preparing these reports, a buyer should ensure that his/her legal representative confirms as soon as possible all matters relating to title including the extent and boundaries of the property and other important matters before exchange of contracts.

Brown & Merry is a trading name of Sequence (UK) Limited which is registered in England and Wales under company number 4268443, Registered Office is Cumbria House, 16-20 Hockliffe Street, Leighton Buzzard, Bedfordshire, LU7 1GN. VAT Registration Number is 500 2481 05.

brown & merry



01296 488111



Aylesbury@brownandmerry.co.uk



5-7 Market Street, AYLESBURY,
Buckinghamshire, HP20 2PN



[brownandmerry.co.uk](https://www.brownandmerry.co.uk)