



**Monks Road, Enfield, EN2 8BG**



**welcome to**

**Monks Road, Enfield**

Spacious and extended four bedroom semi-detached family house situated on this generous corner plot, just minutes from Chase Side Primary School, One Degree and The Wren Academy Schools, Gordon Hill Rail Station (Moorgate Line), shops, restaurants and pubs and within easy access of both the M25 Motorway, greenbelt countryside and Enfield Town with its multiple shopping facilities.

The property is well maintained throughout and has been extended and modernised by current vendors during their tenure and offers spacious and flexible living.



### **Spacious Entrance Hall**

Ceramic tiled floor, understairs storage/meter cupboard, radiator, coving to ceiling, turning staircase to first floor.

### **Dual Aspect Lounge**

22' 5" x 10' 11" ( 6.83m x 3.33m )

Fitted carpet, coving to ceiling, two radiators, sliding double glazed patio doors to garden, attractive cast iron fire with mantel over.

### **Dining Room**

17' 9" x 10' 7" ( 5.41m x 3.23m )

Ceramic tiled floor, double radiator, sliding double glazed patio doors to garden, door to utility room.

### **Study / Snug**

17' 7" x 8' 2" ( 5.36m x 2.49m )

Ceramic tiled floor, double radiator.

### **Kitchen**

15' 5" x 7' 5" ( 4.70m x 2.26m )

Fitted in a range of wood, base and wall cupboards with single bowl stainless steel sink and drainer, inset to work surface, cooker space with extractor fan over, tiled splashback, plumbing for dishwasher, ceramic tiled floor, spotlights to ceiling, door to dining room, double radiator, understairs storage cupboard.

### **Utility Room**

7' 5" x 3' 10" ( 2.26m x 1.17m )

Ceramic tiled floor, plumbing for washing machine, space for tumble dryer, wall mounted gas central heating boiler, extractor fan, door to garage.

### **Cloakroom / WC**

Low flush WC, bracket basin, radiator, ceramic tiled floor, extractor fan.

### **First Floor**

### **Landing**

Fitted carpet, access to loft.

### **Bedroom One**

14' 5" max x 10' 11" ( 4.39m max x 3.33m )

Fitted carpet, radiator, range of integrated wardrobes cupboards with mirrored sliding doors, tiled shower cubicle with curtain and rail, (additional storage cupboards in eaves beyond rear of wardrobe cupboards).

### **Bedroom Two**

17' 8" max x 8' 1" ( 5.38m max x 2.46m )

Fitted carpet, double radiator.

### **Bedroom Three**

17' 8" max x 8' 1" ( 5.38m max x 2.46m )

Fitted carpet, double radiator, built-in wardrobe cupboards to eaves.

### **Bedroom Four**

7' x 6' 11" ( 2.13m x 2.11m )

Fitted carpet, radiator.

### **Bathroom**

Comprises a low flush WC, with concealed cistern, panelled bath with mixer tap, shower attachment, glass shower screen, fitted basin, part tiled walls, sunken spotlights to ceiling, column radiator/towel rail, frosted window to rear, vinyl floor.

### **Outside**

As previously stated, the property occupies a generous corner plot with extensive brick paved off-street parking to front and side for several vehicles.

### **Rear Garden**

Beautifully maintained with mature hedging to side and rear, laid to lawn, paved patio, west facing, mature beds and shrubs including banana trees and more, tap, large timber shed with power and light to side, side pedestrian access, approximately 50' x 34'.

### **Brick Built Garage**

16' 4" x 8' 9" ( 4.98m x 2.67m )

Power and light, up and over door.



**view this property online** [barnfields.co.uk/Property/ENF105736](http://barnfields.co.uk/Property/ENF105736)











welcome to

## Monks Road, Enfield

- Three Reception Rooms
- Spacious Kitchen
- Garage With Own Drive
- Close Proximity Of One Degree And Wren Academy
- Off-Street Parking For Several Vehicles

Tenure: Freehold EPC Rating: D

Council Tax Band: E

# OIEO £710,000



check out more properties at [barnfields.co.uk](https://www.barnfields.co.uk)



Property Ref:  
ENF105736 - 0004

1. MONEY LAUNDERING REGULATIONS Intending purchasers will be asked to produce identification documentation at a later stage and we would ask for your co-operation in order that there is no delay in agreeing the sale. 2. These particulars do not constitute part or all of an offer or contract. 3. The measurements indicated are supplied for guidance only and as such must be considered incorrect. Potential buyers are advised to recheck measurements before committing to any expense. 4. We have not tested any apparatus, equipment, fixtures or services and it is in the buyers interest to check the working condition of any appliances. 5. Where an EPC, or a Home Report (Scotland only) is held for this property, it is available for inspection at the branch by appointment. If you require a printed version of a Home Report, you will need to pay a reasonable production charge reflecting printing and other costs. 6. We are not able to offer an opinion either written or verbal on the content of these reports and this must be obtained from your legal representative. 7. Whilst we take care in preparing these reports, a buyer should ensure that his/her legal representative confirms as soon as possible all matters relating to title including the extent and boundaries of the property and other important matters before exchange of contracts.

Barnfields is a trading name of Sequence (UK) Limited which is registered in England and Wales under company number 4268443, Registered Office is Cumbria House, 16-20 Hockliffe Street, Leighton Buzzard, Bedfordshire, LU7 1GN. VAT Registration Number is 500 2481 05.

## Monks Road, Enfield, EN2

Approximate Area = 1506 sq ft / 139.9 sq m

Garage = 136 sq ft / 12.6 sq m

Outbuilding = 105 sq ft / 9.7 sq m

Total = 1747 sq ft / 162.2 sq m

For identification only - Not to scale



FIRST FLOOR

Please note the marker reflects the postcode not the actual property

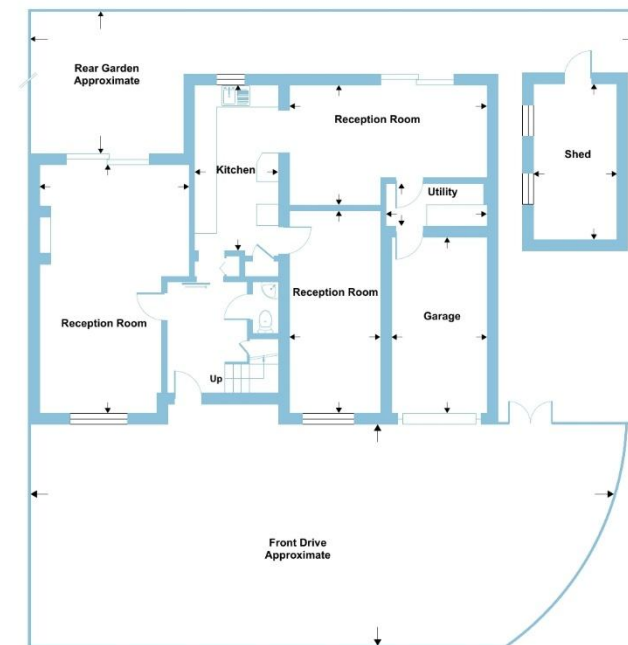

GROUND FLOOR

Floor plan produced in accordance with RICS Property Measurement 2nd Edition, incorporating International Property Measurement Standards (IPMS2 Residential). © nichecom 2025. Produced for Barnard Marcus. REF: 1436199



020 8363 3394



info@barnfields.com



1a Windmill Hill, Enfield, Middlesex, EN2 6SE



[barnfields.co.uk](https://www.barnfields.co.uk)