



Meade Close, W4

£499,950

A spacious three-bedroom ground floor apartment on Chiswick's highly desirable riverside, Strand on the Green. Offering a modern kitchen, separate reception room, underfloor heating and access to well-maintained communal gardens. The residence has the added benefit of no onward chain.

Located close to the River Thames and the highly regarded Strand on the Green Primary School, the property is also within easy reach of local shops and cafes along Thames Road. Excellent transport links include Gunnersbury Station (0.6 Miles) and Chiswick Mainline Station (0.9 Miles), both offering fast access into Central London.

- Three Bedrooms • Ground Floor • No Onward Chain • Underfloor Heating • Separate Reception Room • Strand On The Green •

FLETCHERS

ESTATE AGENTS

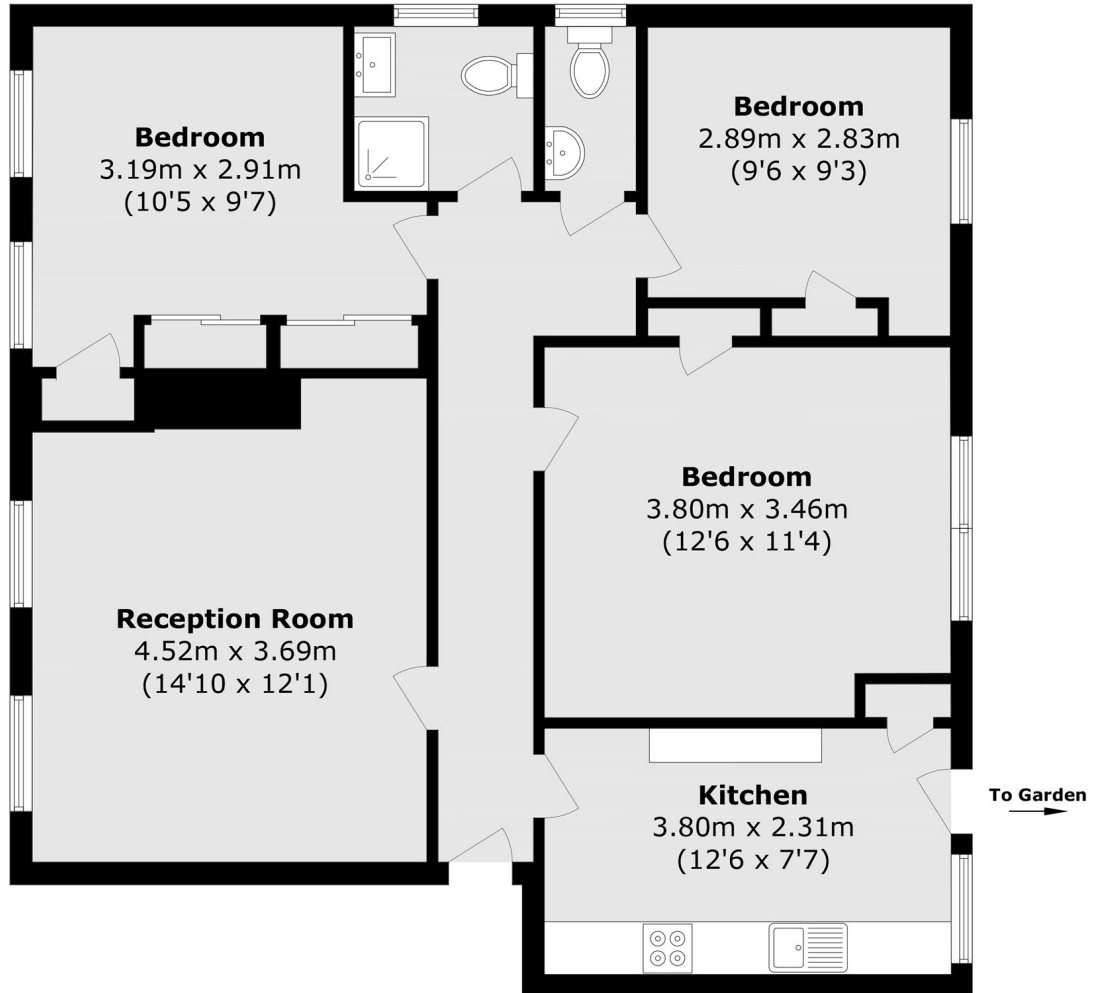

Total area (approx.): 71.1 sq. m (765.0 sq. ft)

Fletchers Brook Green Sales
144 Shepherds Bush Road, Hammersmith, London, W6 7PB
020 7603 1415
brookgreensales@fletcherestates.com

Energy Rating: C. We aim to make our particulars both accurate and reliable. However they are not guaranteed; nor do they form part of an offer or contract. If you require clarification on any points then please contact us, especially if you're traveling some distance to view. Please note that appliances and heating systems have not been tested and therefore no warranties can be given as to their good working order.