



Colvile Road, Wisbech, PE13 2EL

Welcome to

Colvile Road, Wisbech

Located on the popular Colville Road in Wisbech, this immaculately presented four-bedroom detached family home offers generous living space, modern upgrades, and an exceptional rear garden, making it perfectly suited for contemporary family life. The ground floor comprises two spacious reception rooms, ideal for both formal entertaining and everyday living. The centrepiece of the home is the recently renovated open-plan kitchen/diner, finished to a high standard and designed with modern living in mind. Additional benefits include a newly installed downstairs W/C and a bright conservatory which provides a seamless connection to the garden and an additional versatile living area. Upstairs, the property offers four well-proportioned bedrooms, all served by a stunning three-piece family bathroom, beautifully finished with contemporary fittings. Externally, the home truly excels. The property boasts a stunning rear garden, thoughtfully landscaped to create a private and tranquil outdoor space. A particular highlight is the large garden studio, complete with electricity, making it ideal for a home office, gym, hobby room, or additional entertaining space.



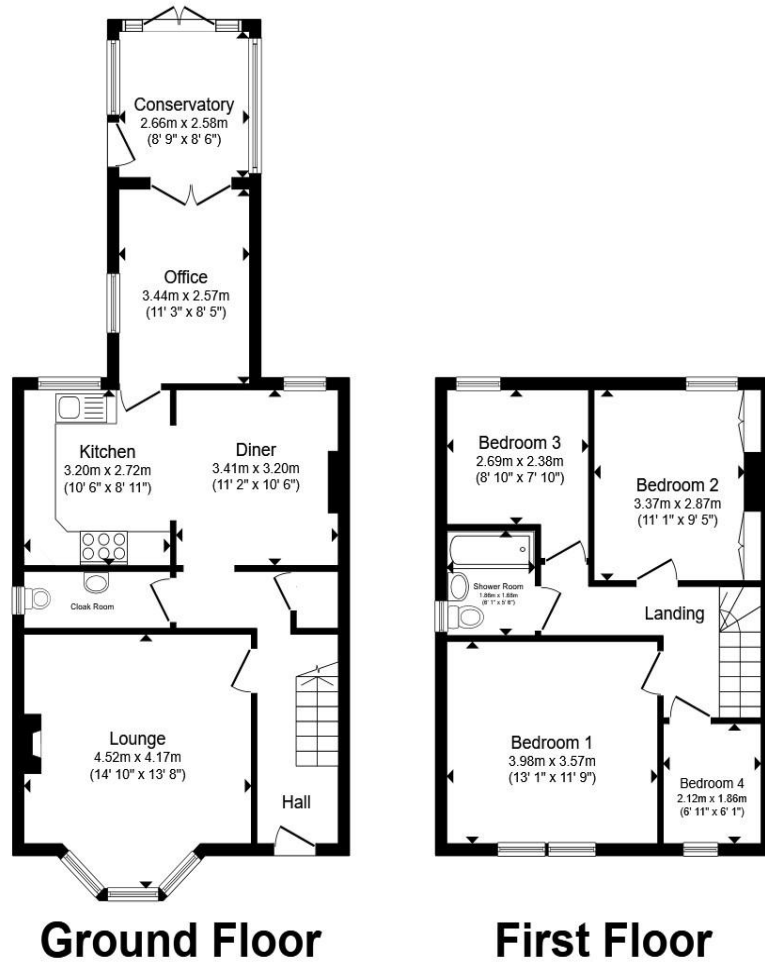

Total floor area 112.6 m² (1,212 sq.ft.) approx

This floor plan is for illustrative purposes only. It is not drawn to scale. Any measurements, floor areas (including any total floor area), openings and orientation are approximate. No details are guaranteed, they cannot be relied upon for any purpose and they do not form part of any agreement. No liability is taken for any error, omission or misstatement. A party must rely upon its own inspection(s). Powered by www.propertybox.io



Entrance Hall

Lounge

Kitchen / Dining Room

Office

Conservatory

Downstairs Wc

First Floor Landing

Bedroom One

Bedroom Two

Bedroom Three

Bedroom Four

Bathroom

Studio

22' 11" approx x 13' 1" approx (6.99m approx x 3.99m approx)

Agents Note:

Heating to the property is currently served by Electric. Please contact the branch for more details' - Upon completion, the existing electric boiler will be disconnected, and the property will be serviced by a gas boiler.

Welcome to

Colvile Road, Wisbech

- FOUR BEDROOMS
- DETACHED
- THREE RECEPTION ROOMS
- STUDIO IN GARDEN
- THREE PIECE BATHROOM

Tenure: Freehold EPC Rating: G
Council Tax Band: C

offers in excess of

£250,000



Please note the marker reflects the
postcode not the actual property

view this property online [williamhbrown.co.uk/Property/WSB128589](https://www.williamhbrown.co.uk/Property/WSB128589)



Property Ref:
WSB128589 - 0006

1. MONEY LAUNDERING REGULATIONS Intending purchasers will be asked to produce identification documentation at a later stage and we would ask for your co-operation in order that there is no delay in agreeing the sale. 2. These particulars do not constitute part or all of an offer or contract. 3. The measurements indicated are supplied for guidance only and as such must be considered incorrect. Potential buyers are advised to recheck measurements before committing to any expense. 4. We have not tested any apparatus, equipment, fixtures or services and it is in the buyers interest to check the working condition of any appliances. 5. Where an EPC, or a Home Report (Scotland only) is held for this property, it is available for inspection at the branch by appointment. If you require a printed version of a Home Report, you will need to pay a reasonable production charge reflecting printing and other costs. 6. We are not able to offer an opinion either written or verbal on the content of these reports and this must be obtained from your legal representative. 7. Whilst we take care in preparing these reports, a buyer should ensure that his/her legal representative confirms as soon as possible all matters relating to title including the extent and boundaries of the property and other important matters before exchange of contracts.

William H Brown is a trading name of Sequence (UK) Limited which is registered in England and Wales under company number 4268443, Registered Office is Cumbria House, 16-20 Hockliffe Street, Leighton Buzzard, Bedfordshire, LU7 1GN. VAT Registration Number is 500 2481 05.



william h brown



01945 464451



Wisbech@williamhbrown.co.uk



20 High Street, WISBECH, Cambridgeshire,
PE13 1DE



[williamhbrown.co.uk](https://www.williamhbrown.co.uk)