

# Kingsway Square | London, SW11



**£2,500 Per Month**

- Exceptional One Double Bedroom Flat • Stunning Victorian School Conversion • 520 Sq Ft • Wooden Flooring Throughout • Concierge Service • Private Balcony & Communal Roof Terrace • Good Natural Light • Close to Battersea Park & Chelsea Bridge • Battersea Power Station Tube Nearby • 2 Minutes Walk to Battersea Park

# Kingsway Square | London, SW11



Exceptional apartment set within an exclusive Victorian School conversion just moments from Battersea Park, a short walk to Chelsea Bridge.

Forming part of the new build section of the development the accommodation comprises large-open plan reception room with fully integrated kitchen, double bedroom with fitted wardrobes and luxury bathroom. The reception room has double doors opening onto a private balcony overlooking attractive communal gardens. Kingsway Square has the benefit of a concierge service, communal roof terrace and secure bike storage.

Ideally located for a excellent transport links with both Queenstown Road and Battersea Park Stations within a few minutes walk (10 minutes to Waterloo and 5 minutes to Victoria) as well as the new Northern Line Tube Stop at Battersea Power Station. Has Tesco Metro on its doorstep as well as a wider selection of local shops, riverside bars and restaurants nearby.

Wandsworth Council Tax Band C. Available from 18th July, furnished.

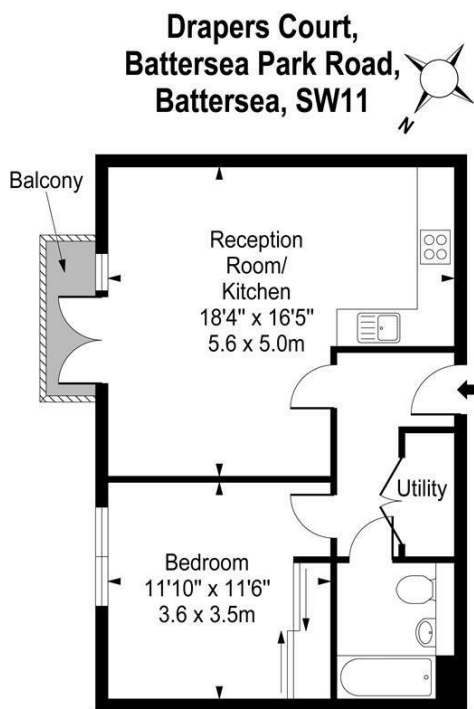

Approx Gross Internal Area **520 Sq Ft - 48.3 Sq M**

For Illustration Purposes Only - Not To Scale  
photosandfloorplans.com ©

Energy Efficiency Rating		Current	Potential
Very energy efficient - lower running costs			
(92 plus) <b>A</b>			
(81-91) <b>B</b>			
(69-80) <b>C</b>		75	76
(55-68) <b>D</b>			
(39-54) <b>E</b>			
(21-38) <b>F</b>			
(1-20) <b>G</b>			
Not energy efficient - higher running costs			
<b>England &amp; Wales</b>		EU Directive 2002/91/EC	
Environmental Impact (CO <sub>2</sub> ) Rating		Current	Potential
Very environmentally friendly - lower CO <sub>2</sub> emissions			
(92 plus) <b>A</b>			
(81-91) <b>B</b>			
(69-80) <b>C</b>		78	79
(55-68) <b>D</b>			
(39-54) <b>E</b>			
(21-38) <b>F</b>			
(1-20) <b>G</b>			
Not environmentally friendly - higher CO <sub>2</sub> emissions			
<b>England &amp; Wales</b>		EU Directive 2002/91/EC	

These particulars are designed to provide a guideline only and cannot be relied upon as a statement of fact. The description represents the opinion of the author and is not intended to provide false or misleading information. Any prospective purchaser should make further checks on its accuracy. All measurements are approximate and floorplans are for representation only.



**Eden Harper**  
64 Battersea Park Road, London, SW11 4JP  
**0207 720 1116**  
info@edenharper.com  
www.edenharper.com