



Lacey Street, Ipswich, IP4 2PL

welcome to

Lacey Street, Ipswich

This well-presented, three storey home is situated close to Ipswich Waterfront and benefits from two 1st floor bedrooms, an open plan ground floor lounge/dining room, a basement kitchen, a basement bathroom and a rear garden.

Basement Kitchen

Eye and base level units in wood effect with marble effect worktop surfaces, mosaic tiled splashback, space for all appliances, spotlights, a stainless steel sink plus drainer and chrome mixer tap, tiled effect flooring, double glazed window to the rear and a door to the garden.

Bathroom

Tiled flooring, one radiator, double glazed window to the rear, spotlights, pedestal wash hand basin, low level WC, extractor fan and a bath with marble effect tiled surround, waterfall showerhead and shower attachment.

Ground Floor Lounge

Open plan room with wood effect flooring, front door, TV point, double glazed window to the front, one radiator and an opening to the dining room.

Dining Room

Wood effect flooring, one radiator, an opening to the lounge and double glazed window to the rear.

First Floor Landing

Carpet flooring and loft hatch.

Master Bedroom

Double glazed window to the front, carpet flooring and one radiator.

Bedroom Two

Double glazed window to the rear, carpet flooring, an airing cupboard and one radiator.

Outside: Front Garden

A concrete frontage with steps up to the front door.

Rear Garden

Steps up to a paved seating area, a grassed area, fully enclosed border and a shed.

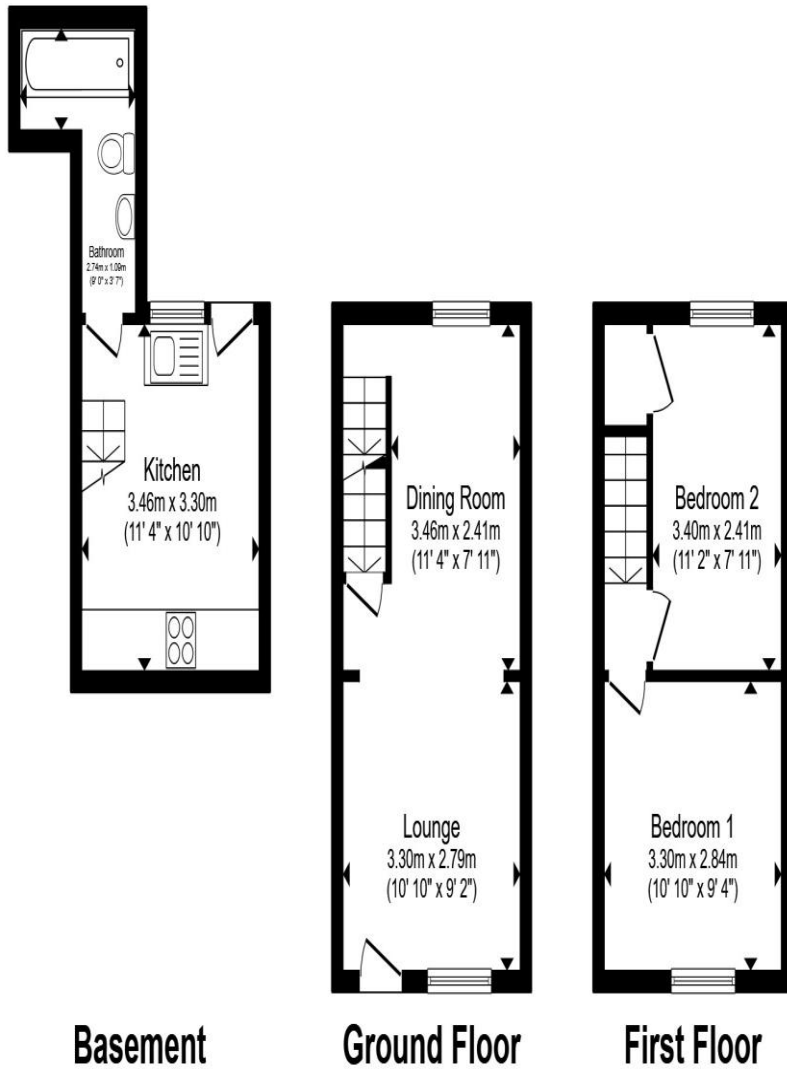

Basement

Ground Floor

First Floor

Total floor area 57.1 m² (615 sq.ft.) approx

This floor plan is for illustrative purposes only. It is not drawn to scale. Any measurements, floor areas (including any total floor area), openings and orientation are approximate. No details are guaranteed, they cannot be relied upon for any purpose and they do not form part of any agreement. No liability is taken for any error, omission or misstatement. A party must rely upon its own inspection(s). Powered by www.propertybox.io



welcome to
Lacey Street,
Ipswich

- Three storey living
- Two 1st floor bedrooms
- Open plan, ground floor lounge/diner
- Basement kitchen & bathroom
- Rear garden

Tenure: Freehold EPC Rating: D
Council Tax Band: A

offers over
£170,000



view this property online williamhbrown.co.uk/Property/IPS121161



Property Ref:
IPS121161 - 0003

1. MONEY LAUNDERING REGULATIONS Intending purchasers will be asked to produce identification documentation at a later stage and we would ask for your co-operation in order that there is no delay in agreeing the sale. 2. These particulars do not constitute part or all of an offer or contract. 3. The measurements indicated are supplied for guidance only and as such must be considered incorrect. Potential buyers are advised to recheck measurements before committing to any expense. 4. We have not tested any apparatus, equipment, fixtures or services and it is in the buyers interest to check the working condition of any appliances. 5. Where an EPC, or a Home Report (Scotland only) is held for this property, it is available for inspection at the branch by appointment. If you require a printed version of a Home Report, you will need to pay a reasonable production charge reflecting printing and other costs. 6. We are not able to offer an opinion either written or verbal on the content of these reports and this must be obtained from your legal representative. 7. Whilst we take care in preparing these reports, a buyer should ensure that his/her legal representative confirms as soon as possible all matters relating to title including the extent and boundaries of the property and other important matters before exchange of contracts.

William H Brown is a trading name of Sequence (UK) Limited which is registered in England and Wales under company number 4268443, Registered Office is Cumbria House, 16-20 Hockliffe Street, Leighton Buzzard, Bedfordshire, LU7 1GN. VAT Registration Number is 500 2481 05.



william h brown



01473 226101



ipswich@williamhbrown.co.uk



16-18 Wolsey House, Princes Street, IPSWICH,
Suffolk, IP1 1QT



williamhbrown.co.uk