



Victoria Road, NW6

£1,900 Per Month

Unfurnished top-floor one-bedroom flat in a converted Victorian house, located on a quiet tree-lined street in the heart of Queen's Park. The property features a bright living room with a fireplace, a separate fully fitted kitchen, a double bedroom, and a modern three-piece bathroom. Ideally situated within walking distance of Salisbury Road's cafés, shops, and restaurants, as well as Queen's Park, with excellent transport links via Queen's Park Station (Bakerloo Line, Zone 2) and 24-hour bus services.



- Lovely 1 bedroom Top Floor Flat
- Offering 533 sq ft of well laid out accommodation
- Stylish modern fitted kitchen
- Transport: Queens Park (Bakerloo- Zone 2)
- Deposit: £2,076
- COUNCIL: Brent (C)



020 8450 9377 - 020 8459 1133
rentals@cameronsstiff.co.uk

Victoria Road, NW6

Approximate Area = 50.5 sq m / 543 sq ft

For Identification only - Not to Scale

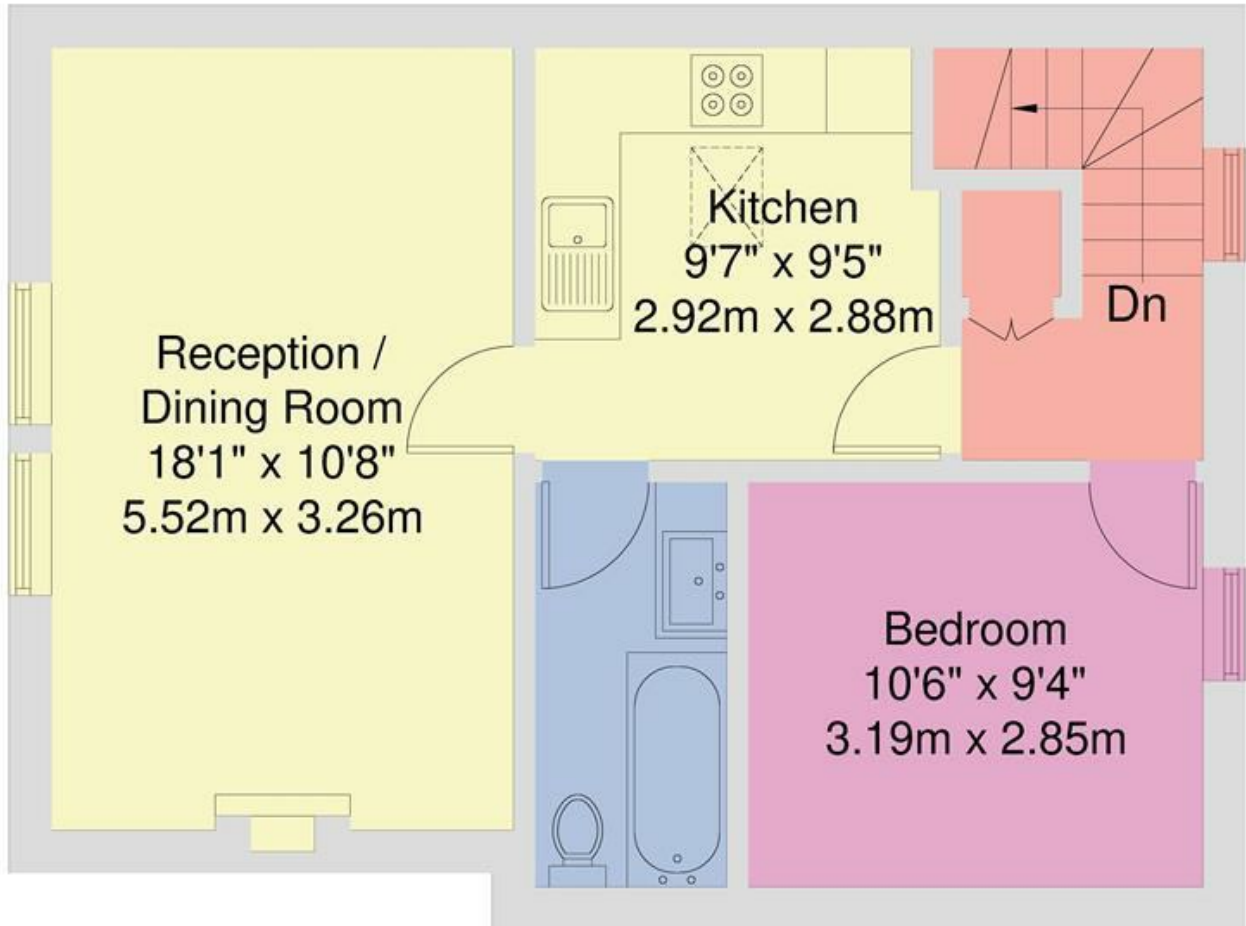

EPC Ref: 15083009 SECOND FLOOR

Ref: 15083009

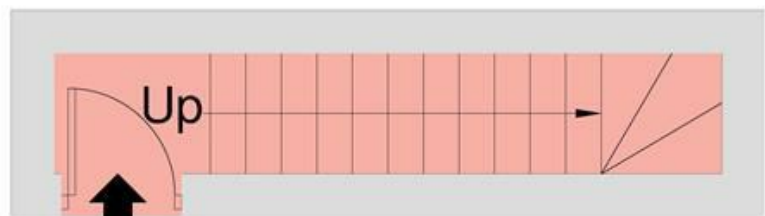

FIRST FLOOR

Disclaimer : Floorplan measurements are approximate and are for illustrative purposes only. While we do not doubt the floorplan accuracy and completeness, you or your advisors should conduct a careful, independent investigation of the property in respect of monetary valuation.

