



Bramble Close, Newborough Peterborough
£220,000 Freehold

**Sharman
Quinney**

Key Features



- Village Location
- Two Bedroom Semi-Detached
- Driveway
- Spacious Lounge Diner
- Close to Local Amenities

Situated in a desirable village location, this charming two-bedroom semi-detached home offers a perfect blend of comfort and convenience. The property features a bright and spacious lounge diner, Kitchen and cloakroom. Upstairs, the home boasts two well-proportioned bedrooms and a family bathroom. Externally, the property benefits from a private driveway offering off-road parking, along with a rear garden. Offering a peaceful setting with local amenities nearby, this home is ideal for first-time buyers, downsizers or investors.

Entrance hallway

Kitchen



Lounge/ Dining Room

Cloakroom

Landing

Bedroom One

Bedroom Two

Bathroom

All measurements are listed on the floor plan.



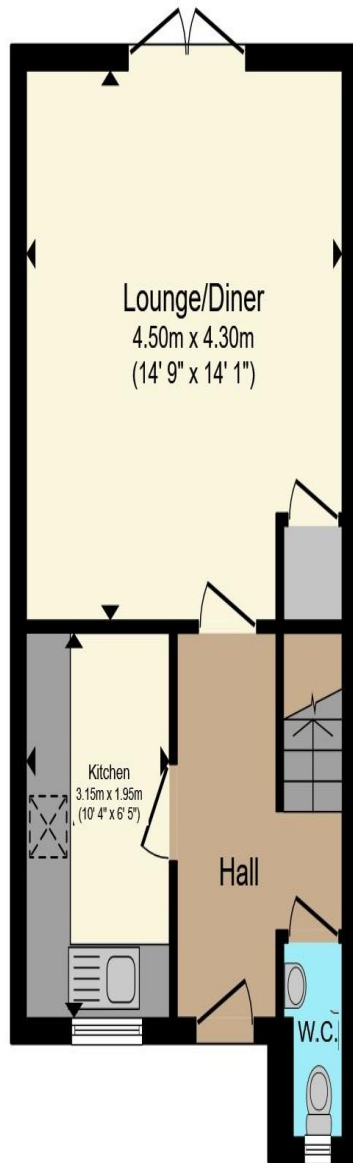

Ground Floor

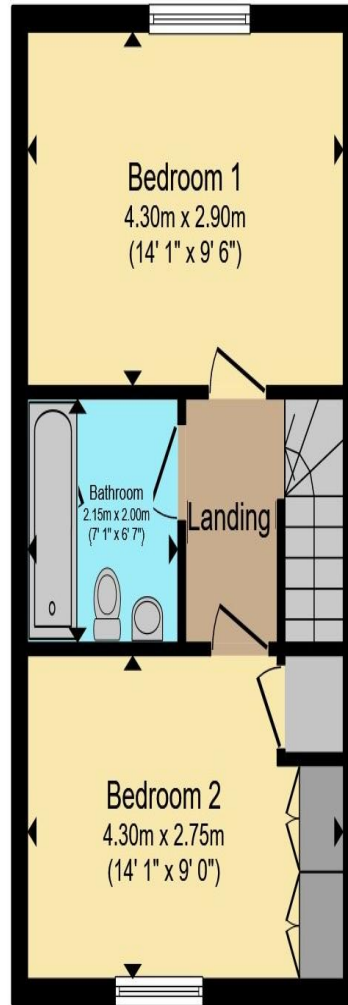

First Floor

This floorplan is for illustrative purposes only and is not drawn to scale. Measurements, floor-areas, openings and orientations are approximate. They should not be relied upon for any purpose and do not form any part of an agreement. No liability is taken for any error or mis-statement. All parties must rely on their own inspections.

To view this property call Sharman Quinney on:
01733 575757

Selling your property?

Contact us to arrange a **FREE** home valuation.

 01733 575757

 Loxley Centre, Werrington, Peterborough,
Cambridgeshire, PE4 5BW

 werrington@sharmanquinney.co.uk

 www.sharmanquinney.co.uk



 SCAN ME



Sharman Quinney Holdings Limited is registered in England and Wales under company number 4174227, Registered Office is Cumbria House, 16-20 Hockliffe Street, Leighton Buzzard, Bedfordshire, LU7 1GN. VAT Registration Number is 500 2481 05.

1: These particulars do not constitute part or all of an offer or contract. 2: The measurements indicated are supplied for guidance only and as such must be considered incorrect. 3: Potential buyers are advised to recheck the measurements before committing to any expense. 4: Sharman Quinney has not tested any apparatus, equipment, fixtures, fittings or services and it is the buyers interests to check the working condition of any appliances. 5: Sharman Quinney has not sought to verify the legal title of the property and buyers must obtain verification from their legal representative. 6: Intending purchasers will be asked to produce identification documentation at a later stage and we would ask your co-operation in order that there will be no delay in agreeing the sale. Ref: WER205881 - 0007

