



St. Dunstons Avenue, W3

£900,000

A well-maintained and presented semi-detached three bedroom family home with a large garden. The property offers plenty of potential to extend both on the ground floor and into the loft, subject to all the usual consents and has no onward chain.



St. Dunstons Avenue is within 500 metres of both Acton Main Line (Elizabeth line) and Acton Central (Overground) stations as well as the shops and amenities of Churchfield Road.

- Three Bedrooms • No Onward Chain • Close To Stations •
- Semi-Detached • Large Garden • Potential To Extend (STPP) •



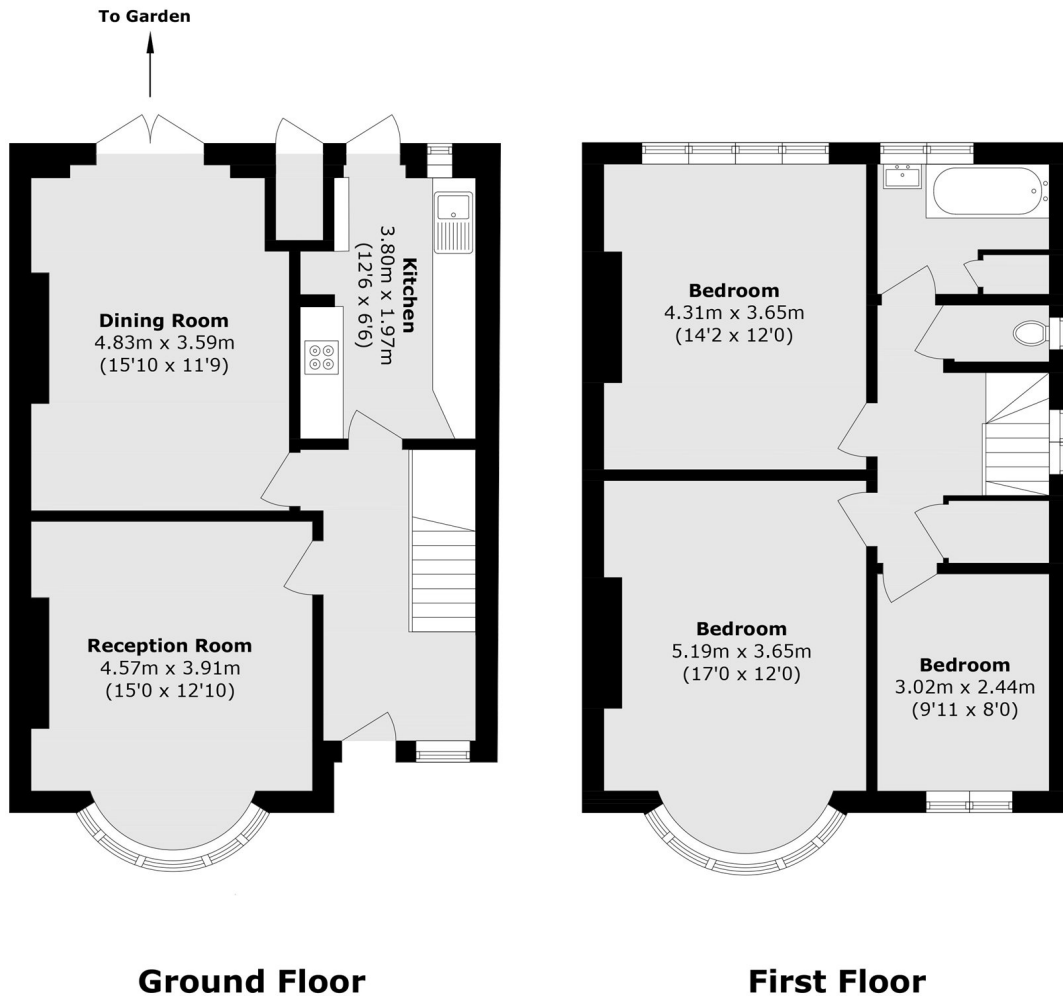

Total area (approx.): 108.7 sq. m (1170.0 sq. ft)

Robertson Smith & Kempson Northfields Sales
116 Northfield Avenue,
London, W13 9RT
020 8566 2340
northfieldssales@robertsonsmithandkempson.co.uk

Energy Rating: D. We aim to make our particulars both accurate and reliable. However they are not guaranteed; nor do they form part of an offer or contract. If you require clarification on any points then please contact us, especially if you're traveling some distance to view. Please note that appliances and heating systems have not been tested and therefore no warranties can be given as to their good working order.